



Brazoria Drainage District No. 4

4813 W. Broadway
Pearland, TX 77581

Tel: 281-485-1434
Fax: 281-485-0065

Brazoria Drainage District No. 4
Benchmark Sheet

Benchmark No. M-9

General Location: Old Alvin Road at Mary's Creek

Latitude: 29° 33' 11.37" N

Longitude: 95° 16' 37.93" W

Grid Northing: 13,767,503.57

Grid Easting: 3,151,861.97

State Plane Coordinates, Texas South Central Zone
(4204), NAD 83

Elevation: 48.04 NAVD 88, 2001 Adjustment

Benchmark No. M-9 is a brass disk stamped 'Brazoria Drainage District No. 4 BM No. M-9', set on the downstream side of concrete bridge near stream centerline, at Old Alvin Road and Mary's Creek, east side of Old Alvin Road, in KeyMap 615P near Unit B100-00-00.

Date: 05/09/13

Revised 09/11/15 to correct elevation.

Detail Sketch

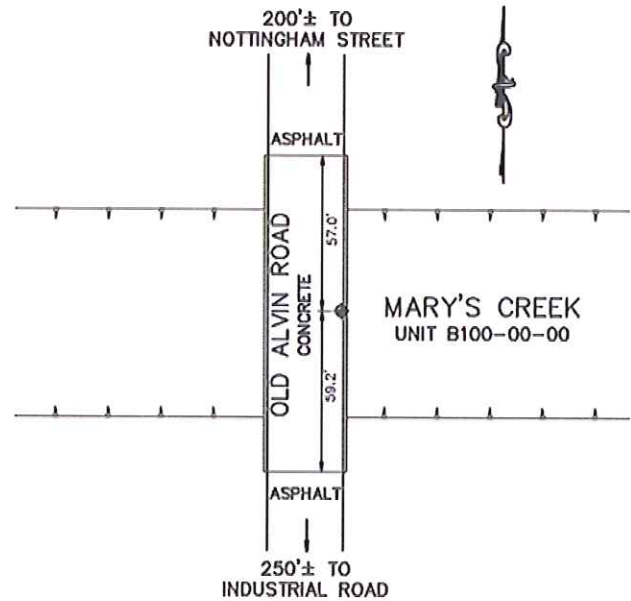

Photo – Station Detail



Photo – Station Area

